



Information for all moving about at AFLD industrial waste treatment plant in Tarm



**Environmental and health and safety guidelines
for all moving about the AFLD area**

AFLD I/S

D2012-951 v4 dec 2011

www.afld.dk

Tlf. 97 37 33 77

afld@afld.dk

Environmental and health and safety rules:

Upon arrival to AFLD, please contact the reception for information about the workplace, rules etc.

Everyone who moves about the AFLD area must comply with the environmental and health and safety rules and be familiar with the AFLD's environmental management system and act accordingly. Environmental Handbook can be borrowed from the administration.

AFLD's environmental policy:

It is AFLD's general environmental policy to

- provide waste producers an environmentally friendly waste treatment,
- fully exploit the resources in waste,
- guarantee the employees a good and safe working environment.



Environment:

- Waste and recycling materials must be unloaded at the places specified by AFLD's staff.
- Washing of the containers must be conducted only in the designated washing area.

- All waste produced at the AFLD area must be separated according to the source.
- Oil and chemical waste must be stored in suitable, labelled containers.
- Oil spills must be immediately collected.
- Oil spills must be reported to the AFLD's staff.



Other:

- Terms agreed between AFLD and external employers must be observed.
- AFLD and / or supervisor / employer must be made aware of all the defects that cannot be corrected.

Health and safety:

When driving:

- Speed limits in the AFLD area **must** be respected.
- The one-way traffic signs **must** be respected.
- Please, take special care of all who are near the vehicle when driving.



When walking:

- When leaving the vehicle cab, you **must** wear safety vest or any other visibility clothing of minimum Class 2 according to the EN471 regulation. People who frequently move about the AFLD area are expected to have their personal safety clothing. Others may borrow vests at the reception.



- Be aware of any working vehicles and make sure to make eye contact with the driver.

Repair, maintenance, etc.:

- During repairs, maintenance and cleaning of the machines, their main power switch must be turned off and secured with a padlock.

Remember, you are the best to take care of yourself!

Containers:

- When covering and uncovering the containers without a roll-up tarp, **do not** climb on the containers.
- One **must not** put together the net and the tarp on the road.
- People on foot must not get closer than **2 meters** from the edge of the unloading ramps.



- The container's door should either be opened and maintained at an angle of max. 100° in relation to the rear, or be top-hung.
- During unloading onto the ground it is acceptable that the doors are fastened to the container's sides.

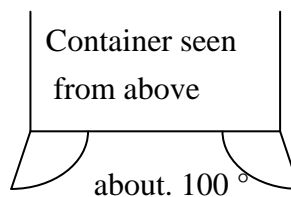

Other precautions:

- Personal protective and safety equipment **must** be used whenever it is mandatory.
- The box with earplugs can be found behind Gate 9 in Hall 3 North.
- In fire or explosion risk areas, smoking ban **must** be observed.
- Please, pay attention to the location of the nearest fire fighting equipment
 - First aid kit can be found in the administration.



Exits / emergency exits

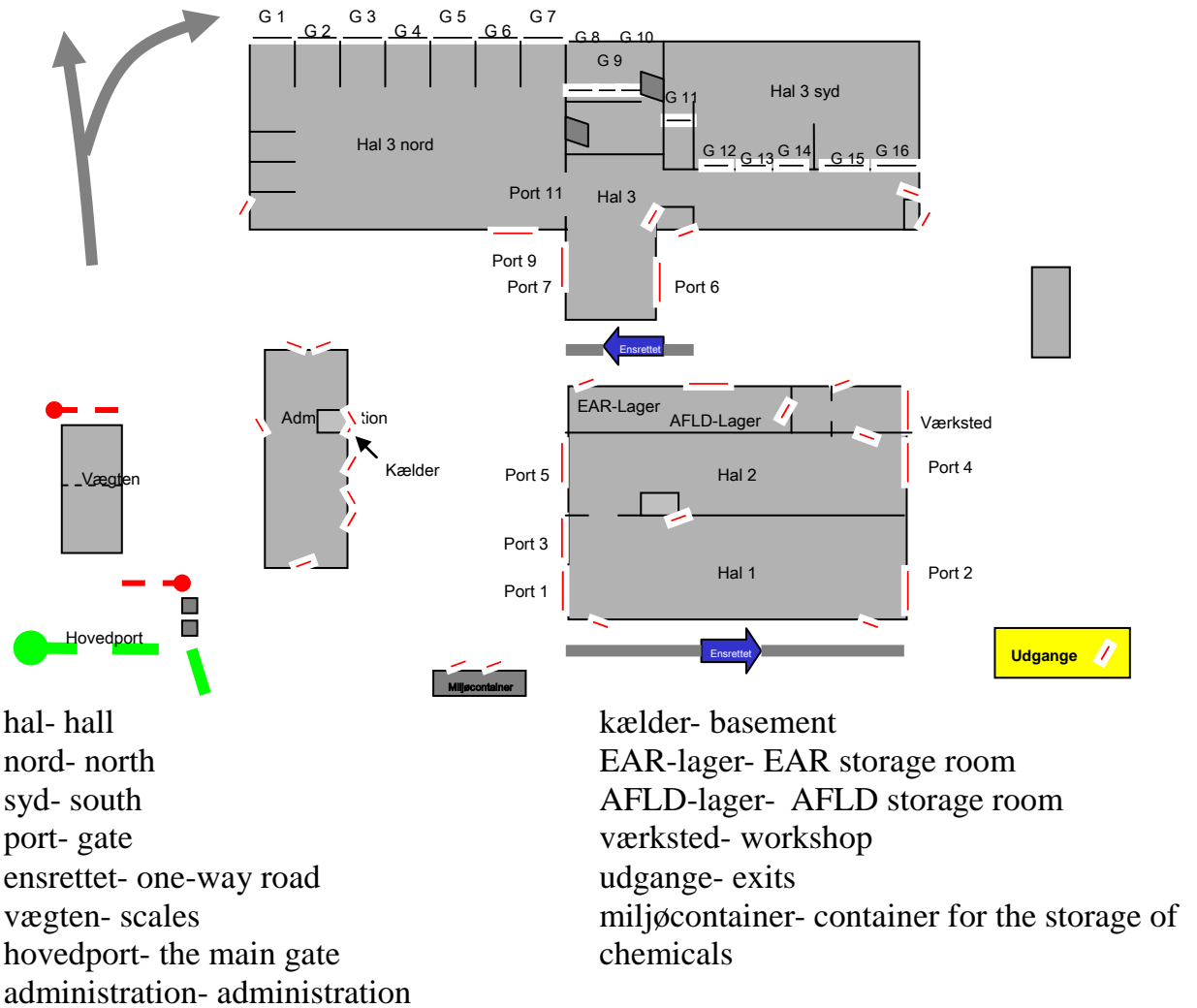

The location of fire-fighting equipment

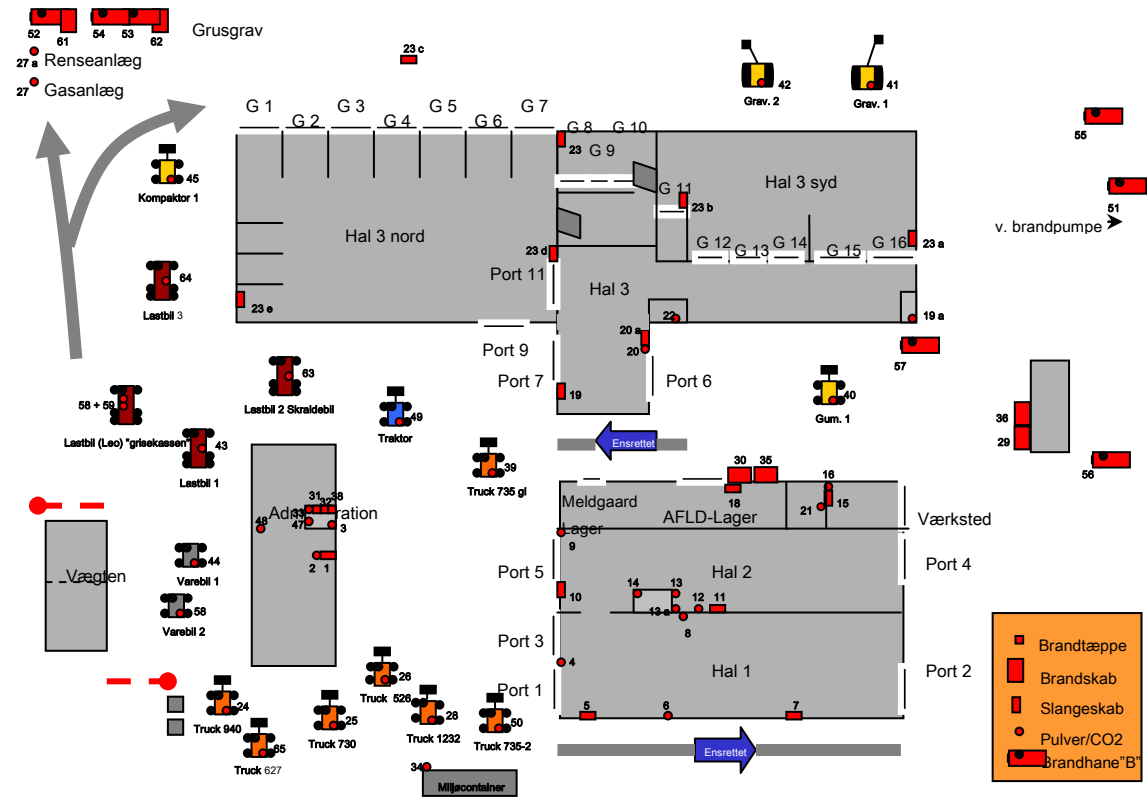

grusgrav- gravel pit

renseanlæg- waste water treatment plant

gasanlæg- gas installation

kompaktor- compactor

lastbil- truck

skraldebil- garbage truck

varebil- van

traktor- tractor

truck- truck

brandpumpe- fire pump

brandtæppe- fire blanket

brandskab- fire cabinet

slangeskab- hose cabinet

pulver/CO2- dry powder/CO2 fire extinguishers

brandhane- fire hydrant

We have both dry powder and CO2 fire extinguishers located in different places.

REMEMBER that CO2 fire extinguishers CANNOT be used towards people because the carbon dioxide used in them is at a temperature below -200 degrees C



In case of a fire or other accident, contact the shift leader or immediately create his or her replacement:

1. Martin 22 67 92 09
2. Ejnar 20 23 23 77
3. Tommy 40 18 32 77
4. Peter N. 25 26 90 07

In case of an evacuation, everyone should gather in the administration building. If there happens to be a fire in the administration building, everyone should gather at the square outside the main gate.

Violation of the safety rules
may result in dismissal!

Take care of yourself !

- and others

- and the environment